

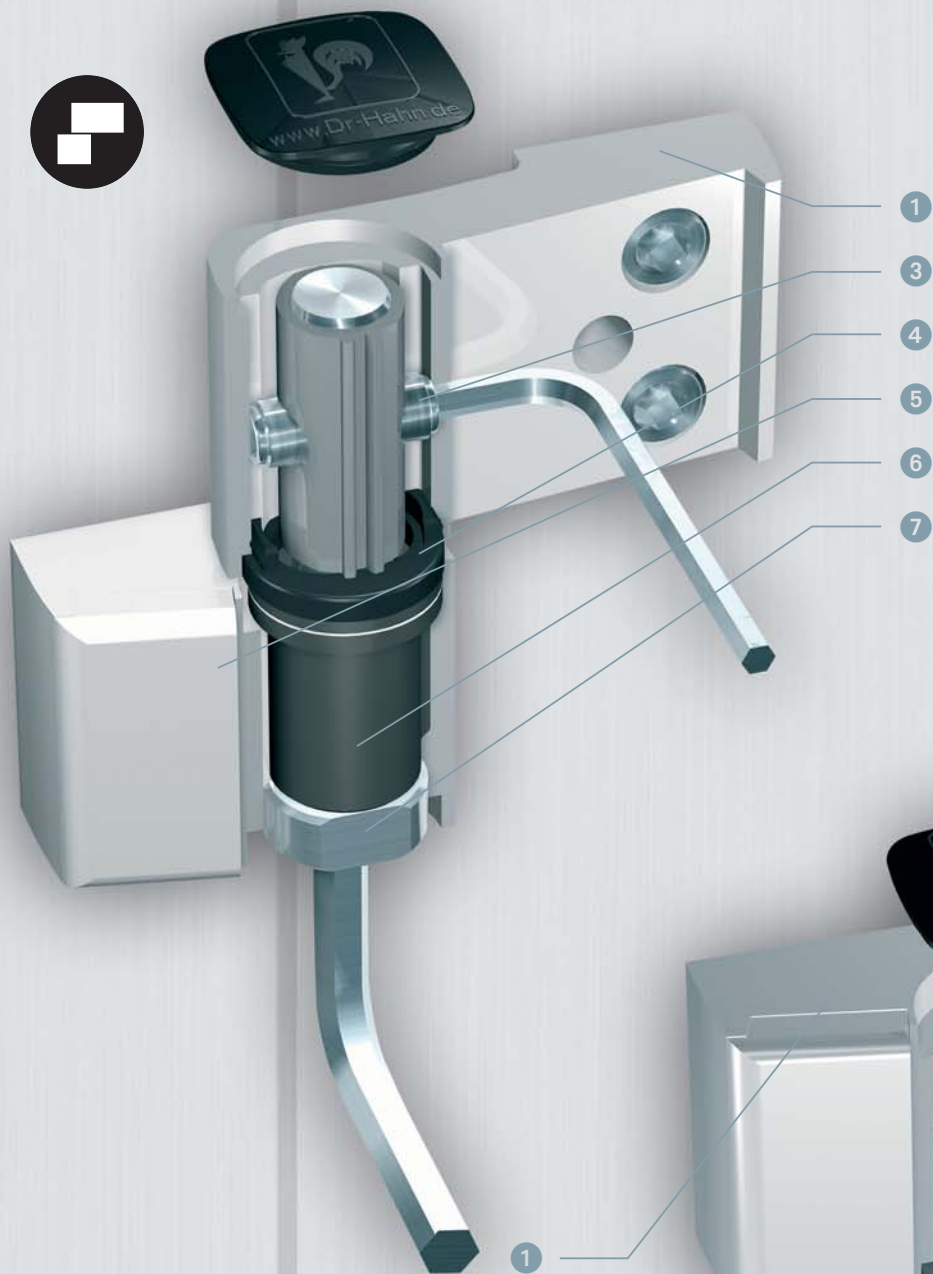

FAÇADE
CREATIONS

Universal Hinge
Guide



- 1
- 2
- 3
- 4
- 5
- 6
- 7

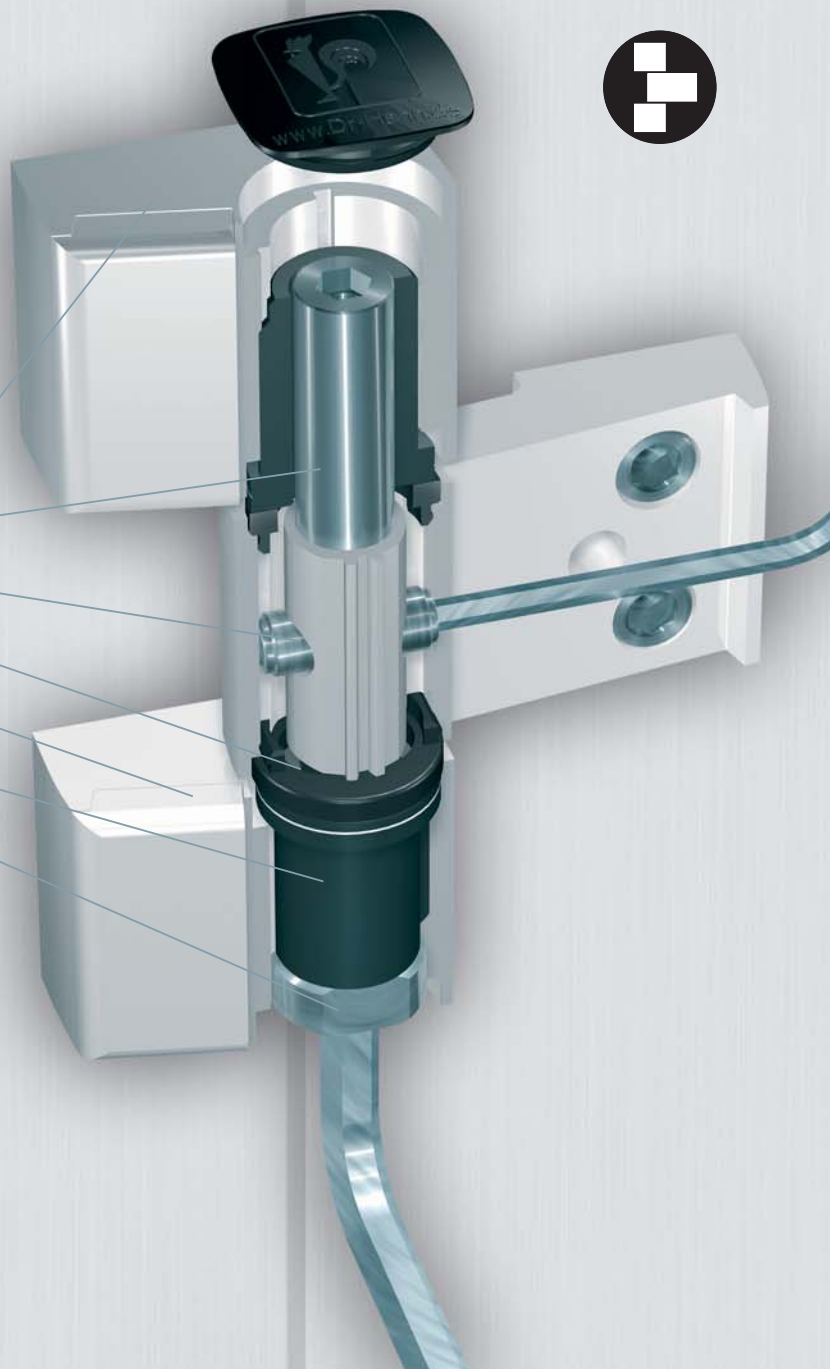



Hahn Series 60 AT

For all doors comprising metal profile sections

- 1 **Screw-on hinge of extruded aluminium** – withstands significant pressure and tensile forces
- 2 **Split stainless steel pins** – for easier disassembly
- 3 **Horizontal adjustment** ± 2 mm on installed doors – this ensures an optimum fit
- 4 **Both parts of the hinges are equipped with a synthetic sleeve** which in turn offers – improved antifriction property
- 5 **Cover strip with clamping function** – easy installation
- 6 **Adjust sealing pressure** – by turning the bearing bushing ± 0.5 mm (individual variations without sealing pressure fine-tuning)
- 7 **Height adjustment using integrated lifting and lowering spindle** – continually variable $+ 3$ mm/ -2 mm and easy adjustment

Other advantages

- Adjustable in six directions, without having to loosen the fastening screws
- Variable horizontal and vertical adjustments possible even with door closed
- Capable of supporting up to 220 kg (3-piece) or 140 kg (2-piece) depending on the design of the profile sections
- Available for all common aluminium and steel profile sections
- CE-certified: hinge class 14 (2-piece)/hinge class 12 (3-piece)
- Hahn universal hinges are certified for fire-proof doors (Ü label)
- All metal parts of the hinge are protected against corrosion. Stainless steel version available for abnormal stress
- The hinge system offers a variety of possible combinations and mounting options for inward and outward opening doors with alternating profile and corner post construction
- Can be used on left or right
- Special designs for folding doors and intrusion-resistant doors
- Hinges available in anodised and RAL colours
- Bearing point maintenance-free – no lubrication necessary

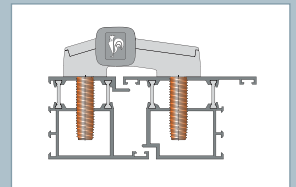
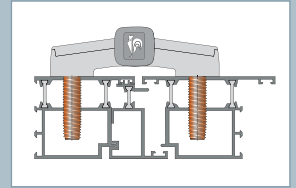
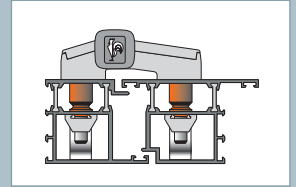
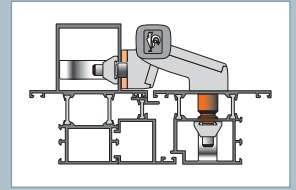



Hahn Series 60 AT ...



... more convenience for door makers

A hinge for (almost) every application:
Hahn Series 60 AT hinges are universally usable for almost all system profiles. They are durable and always remain stable even when subject to intensive use. Both parts of the hinge are equipped with a low-maintenance bearing bushing. That improves the antifriction properties for several hundred thousand cycles. Moreover, it can be adjusted in six directions – by one person and without having to loosen the fastening screws.



Installation instructions

Fastening method screw anchor

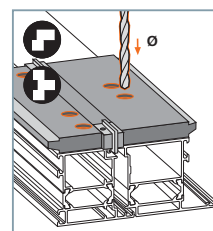

Drill 11 mm diameter holes.

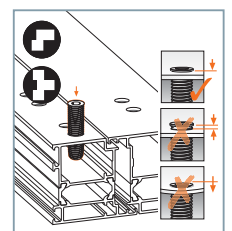

Screw-in screw anchor until flush with surface.



Convenient and reliable

The clamping function of the cover strips is especially convenient. The snap mechanism can be released using a standard tool. To contribute to protection against break-ins, Hahn offers security sets as an accessory for doors that open outwards. The hinge system offers a variety of possible combinations and mounting options for inward and outward opening doors with alternating profile and corner post construction. Only limitation: For individual situations (e.g. corner post constructions) the sealing pressure cannot be fine-tuned as a result of the system.

Adjustment instructions

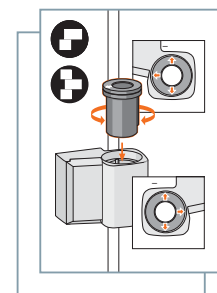

Adjusting the sealing pressure
 Increase sealing pressure: -0.5 mm , mark points towards the door. Decrease sealing pressure: $+0.5\text{ mm}$, mark points away from the door.

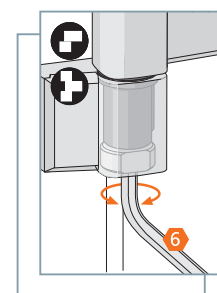

Adjusting the height
 $+3/-2\text{ mm}$

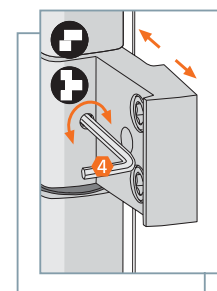

Horizontal adjustment
 $\pm 2\text{ mm}$

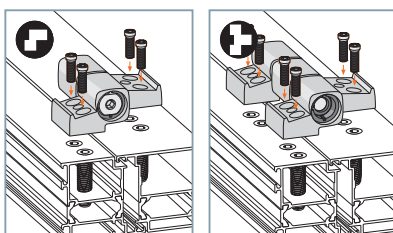

Secure hinges with screws in the internal threading of the screw anchor ($20-25\text{ Nm}$).

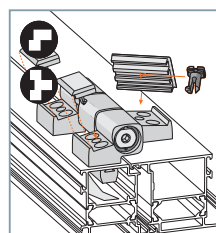

Slide plastic locking plug into cover strip. Snap caps in place.



For all doors comprising metal profile sections











Be it main doors, side doors or functional doors, interior, exterior or entry doors, the Hahn Series 60 AT is a door hinge that performs as expected for the long term. Before a Hahn hinge can be rolled out, the ready-for-production hinge is subjected to testing with over 200,000 opening cycles. In doing so, the hinge must also prove itself under unfavourable conditions. Only after these tests are successfully completed, can the hinge be released. This guarantees that a Hahn hinge is reliable over the long term, a benefit that architects, system suppliers, door makers and building owners all appreciate.

MADE IN GERMANY

CE Certificate included

Both hinge versions of the Series 60 AT were tested by a testing laboratory with regard to a high load capacity. With hinge class 14, the 2-piece version attained the currently highest rating for single-axis door hinges. The 3-piece version received the hinge class 12 due to special testing criteria, whereby the testing laboratory certified a high load capacity. Standard 3-piece hinges of the Series 60 AT may also be used on smoke-resistant and fire safety doors.



								
	Service classes	Durability	Weight of test door	Fire resistance	Security	Corrosion resistance	Intrusion protection	Hinge class
SERIE 60 AT 	4	7	7	0	1	4	0	14
SERIE 60 AT 	4	7	5	1	1	4	1	12

SERIE 60 AT EC Certificate No. 1309-CPD-0003

The classification **4 7 7 0 1 4 0 14** means: A door hinge for (4) very heavy usage, which has undergone endurance testing of (7) 200,000 cycles, for a door with dimensions of up to (7*) 160 kg, not suited for (0) fire and smoke protection, possesses a (4) corrosion resistance of 240 h and can be used on (0) doors that are not rated as intrusion-resistant.

SERIE 60 AT EC Certificate No. 1309-CPD-0001

The classification **4 7 5 1 1 4 1 12** means: A door hinge for (4) very heavy usage, which has undergone endurance testing of (7) 200,000 cycles, for a door with dimensions of up to (5**) 100 kg, suited for (1) fire and smoke protection, possesses a (4) corrosion resistance of 240 h and can be used on (1) intrusion-resistant doors.

* In addition to that, testing was conducted based on 20 cycles with 320 kg and 5 cycles with 480 kg and successfully completed in accordance with EN 1935.

** In addition to that, testing was conducted based on 20 cycles with 200 kg and 5 cycles with 300 kg and successfully completed in accordance with EN 1935. The product verifiably withstands a heavy load of at least 6.0 kN.



Simply revolutionary

The Hahn screw anchor is an anchor of many talents for door hinge mounting technology. It is faster, stronger and more effective than conventional solutions. Together with Hahn's Series 60 AT hinges, it allows for the first time repairs and modification of the position of hinges in sections which require special care. Moreover, it permits the mounting of additional hinges for doors already installed, provided that the wall thickness of the section is at least 1.6 mm and the screw anchor is seated in at least two walls. In combination with the Series 60 AT, the Hahn screw anchor offers additional stability and value in the workshop.



Hinge excursion in mm

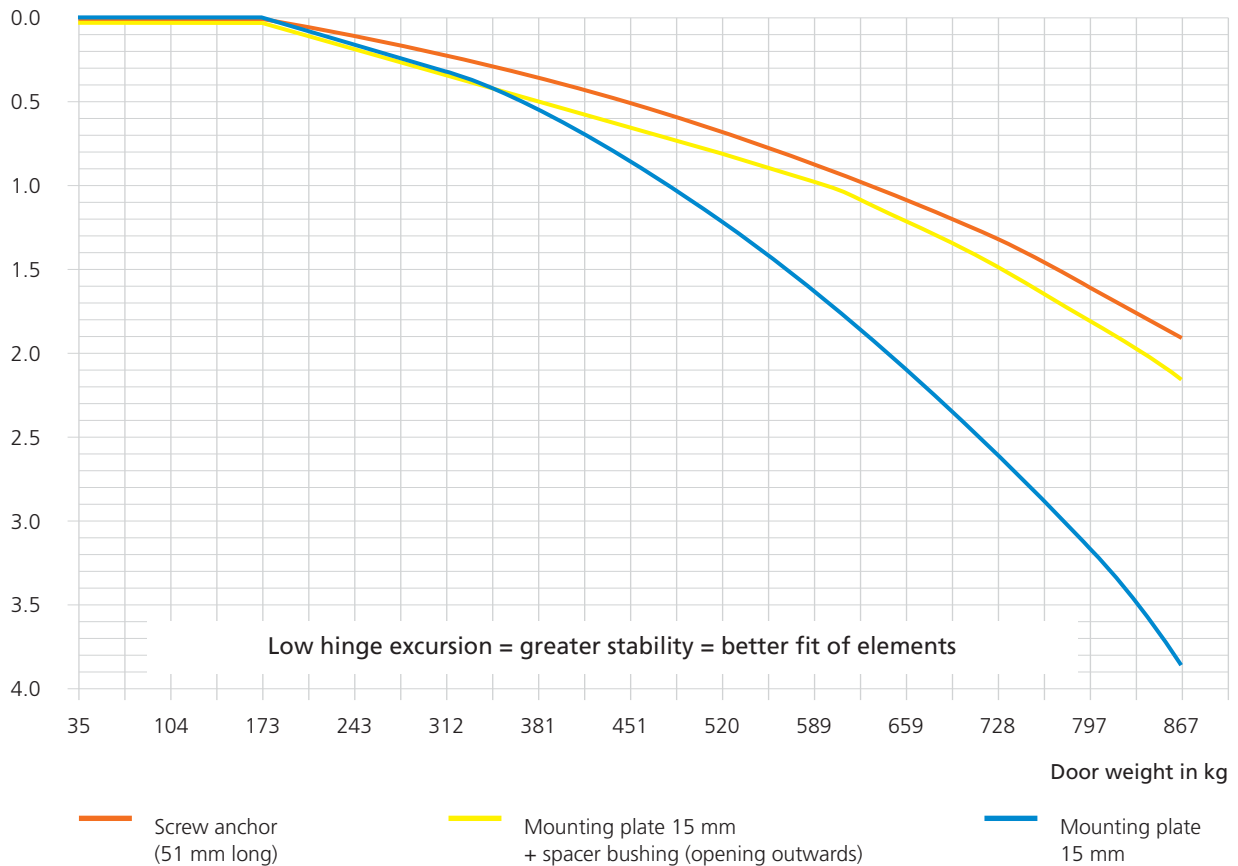

Load when door is open 90° (theoretical weight of doors)



Hahn Series 60 AT

Universal hinge for metal doors

SYSTEM

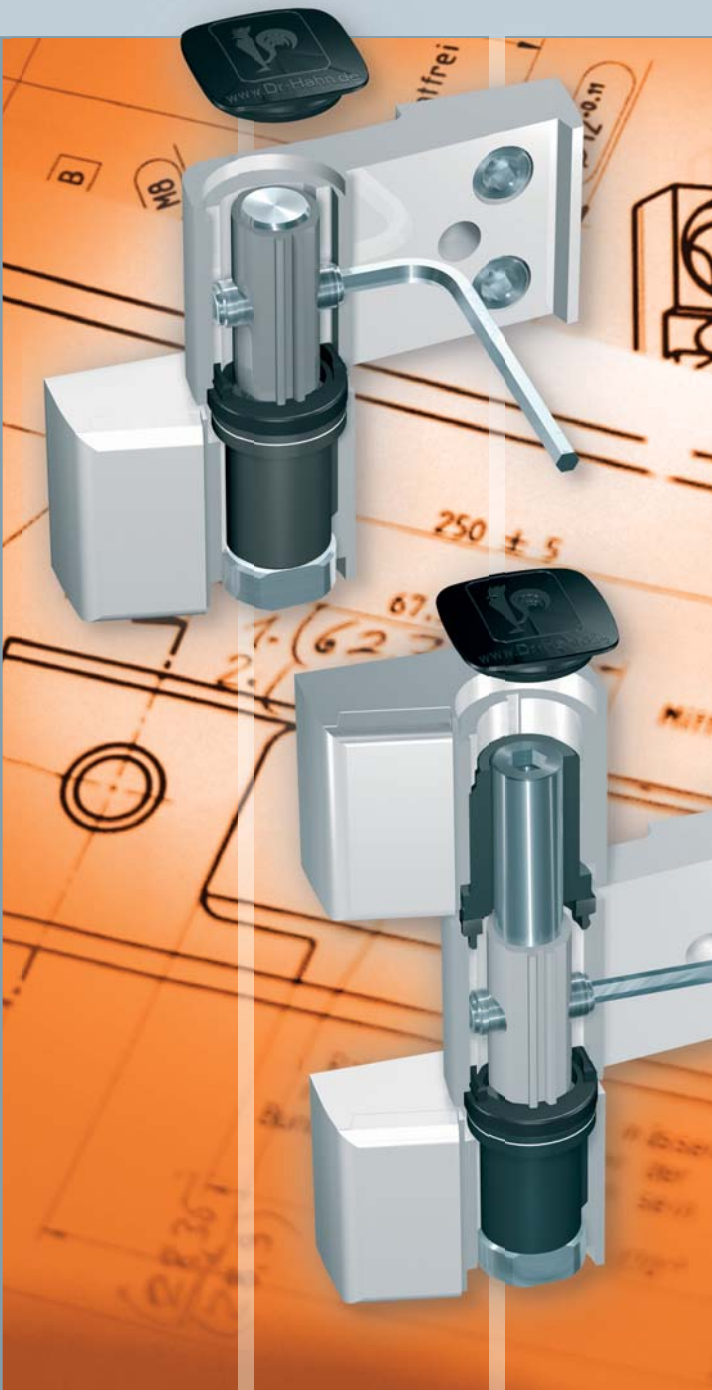

System/Application

- **Material**
Made of of extruded aluminium
- **Fastening methods**
Fastened using section reinforcement plates: 15 and 21 mm. Or Hahn's screw anchor as an alternative
- **Versions**
Two pivots: 20 mm and 36 mm
- **Load capacity**
Depending on profile section design, max. 140 kg (2-piece), max. 220 kg (3-piece)
- **Adjustability**
Door leaf adjustable in six directions:
 - Horizontal adjustment, variable up to ± 2 mm
 - Vertical adjustment using integrated lifting and lowering spindle, raising + 3 mm, lowering – 2 mm
 - Adjust sealing pressure by turning the bearing bushing ± 0.5 mm – individual variations without sealing pressure fine-tuning
- **Approvals**
Tested on smoke-retardant doors and fire safety doors
- **Certifications**
CE-certified as per EN 1935, hinge class 14 and hinge class 12
- **Colours**
Hinges available in anodised and RAL colours
- **Doors open up to 180°**
- **Bearing point maintenance-free**

Drilling jigs

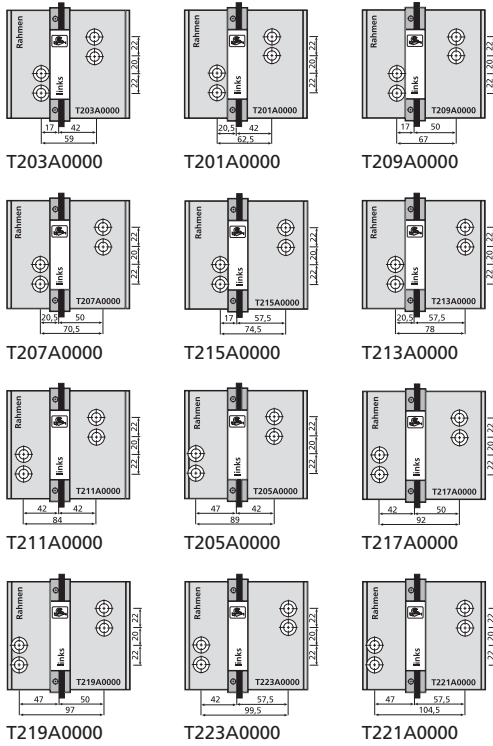

Drilling jigs

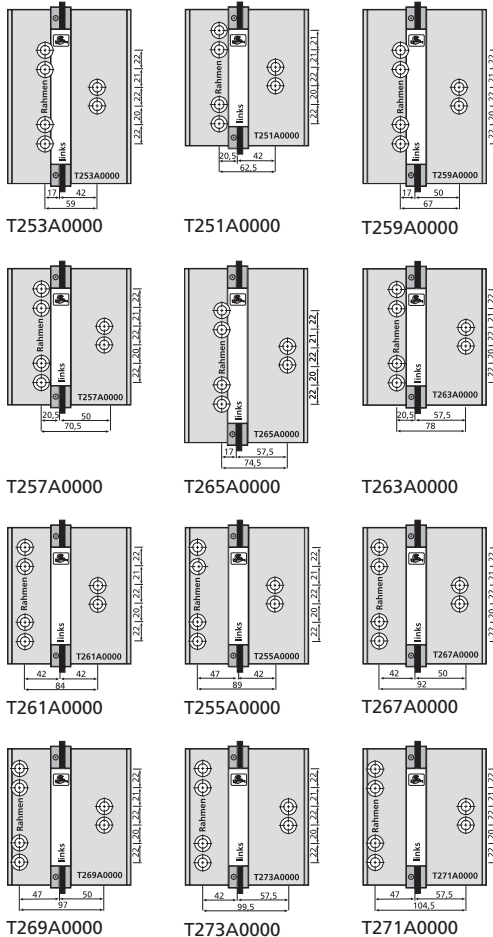

General suggestions for hinge placement

The following design fundamentals are authoritative for hinge placement: size and weight of door, wall thickness of section, frame design, how the door opens, type of loading, hinge mounting. This information is essential for a precise design calculation.

	Object	max. door size [mm]	max. door weight [kg]	Upper door closer	Swing door drive mechanism	Closing sequence controller
Normal usage	Detached house	1,250 x 2,000	120			
	Detached house	1,250 x 2,000	140			
	Building with multiple dwellings	1,250 x 2,000	120			
	Building with multiple dwellings	1,250 x 2,000	140			
	Building with multiple dwellings	1,250 x 2,000	120	■		
	Building with multiple dwellings	1,250 x 2,000	140	■		
Heavy usage	Hospital, school, ...	1,250 x 2,000	120	■		
	Hospital, school, ...	1,250 x 2,000	140			
	Hospital, school, ...	1,250 x 2,000	120		■	
	Hospital, school, ...	1,250 x 2,000	140		■	
	Hospital, school, ...	1,250 x 2,000	120			■
	Hospital, school, ...	1,250 x 2,000	140			■

These general hinge placement suggestions take into account frame sections of normal width (approx. 45 mm) with wall thicknesses of approx. 2 mm. Since the individual door frame systems vary significantly in terms of projected widths and wall thicknesses and the mounting of hinges to the frame play a major role, we recommend that you make use of our free design calculation service, should you have any doubts. To determine the necessary placement of hinges, various information is required. Please request our questionnaire on hinge placement. **Important:** All statements and calculations relate exclusively to Original Hahn hinges and take into account their specific characteristics.

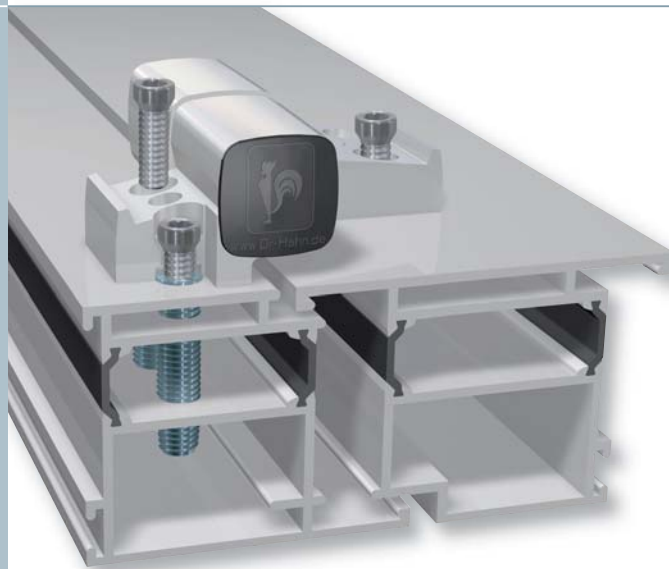



Hahn screw anchor plus
Hahn Series 60 AT:
ideally suited for
retrofitting hinges

Recommended hinge placement **Arrangement**

 Distance from door edge
approx. 150 mm

 Third hinge approx.
150 mm below the
top hinge

 Distance from door edge
approx. 150 mm

 Third hinge approx.
150 mm below the
top hinge

 Third hinge approx.
150 mm below the
top hinge

 Third hinge approx.
150 mm below the top
hinge, fourth in middle

 Third hinge approx.
150 mm below the
top hinge

 Third hinge approx.
150 mm below the top
hinge, fourth in middle

 Third hinge approx.
150 mm below the
top hinge



 Third hinge approx.
150 mm below the top
hinge, fourth in middle

 Third hinge approx.
150 mm below the
top hinge

 Third hinge approx.
150 mm below the top
hinge, fourth in middle

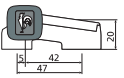
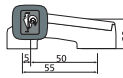

Versions for installation with the Hahn screw anchor

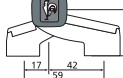
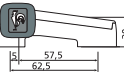
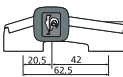
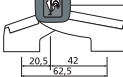
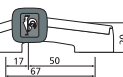
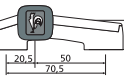
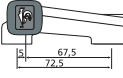
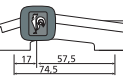
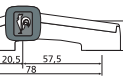
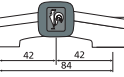
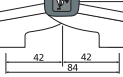
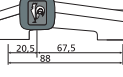
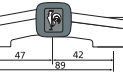
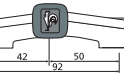
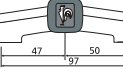
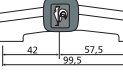
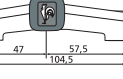
 A735 □ ○ 000 A785 □ ○ 000	 A736 □ ○ 000 A786 □ ○ 000	 A703 □ ○ 000 A753 □ ○ 000	 A704 □ ○ 000 A754 □ ○ 000
 A738 □ ○ 000 A788 □ ○ 000	 A701 □ ○ 000 A751 □ ○ 000	 A702 □ ○ 000 A752 □ ○ 000	 A709 □ ○ 000 A759 □ ○ 000
 A707 □ ○ 000 A757 □ ○ 000	 A737 □ ○ 000 A787 □ ○ 000	 A715 □ ○ 000 A765 □ ○ 000	 A713 □ ○ 000 A763 □ ○ 000
 A711 □ ○ 000 A761 □ ○ 000	 A712 □ ○ 000 A762 □ ○ 000	 A725 □ ○ 000 A775 □ ○ 000	 A705 □ ○ 000 A755 □ ○ 000
 A717 □ ○ 000 A767 □ ○ 000	 A719 □ ○ 000 A769 □ ○ 000	 A723 □ ○ 000 A773 □ ○ 000	 A721 □ ○ 000 A771 □ ○ 000

Other applications available on request



Bearing points made of
maintenance-free plastic
containing Teflon – do not
lubricate!



Installation with the mounting plate or expansion bushing

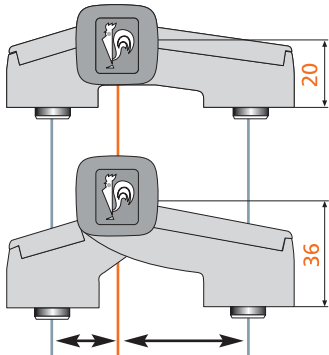

Bore hole gauge	Door/frame combination for inward opening doors (example)		Door/frame combination for outward opening doors (example)		Door/frame combination for inward opening doors with alternating section (example)	
	Pivot		Pivot		Pivot	
	20 mm	36 mm	20 mm	36 mm	20 mm	36 mm
17 42 mm	59 mm	A703 A753	A704 A754	A703 A753	A704 A754	
17 50 mm	67 mm	A709 A759	A710 A760	A709 A759	A710 A760	
20.5 42 mm	62.5 mm	A701 A751	A702 A752	A701 A751	A702 A752	
20.5 50 mm	70.5 mm	A707 A757	A708 A758	A707 A757	A708 A758	
17 57.5 mm	74.5 mm					A715 A765 A716 A766
20.5 57.5 mm	78 mm					A713 A763 A714 A764
42 42 mm	84 mm					
42 50 mm	92 mm					
42 57.5 mm	99.5 mm					
47 42 mm	89 mm					
47 50 mm	97 mm					
47 57.5 mm	104.5 mm					
20.5 42 mm						
20.5 57.5 mm						

**|Item number on request

***|We recommend using a 3-piece variation

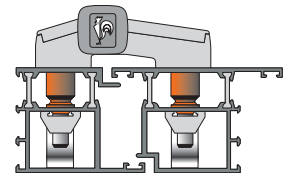
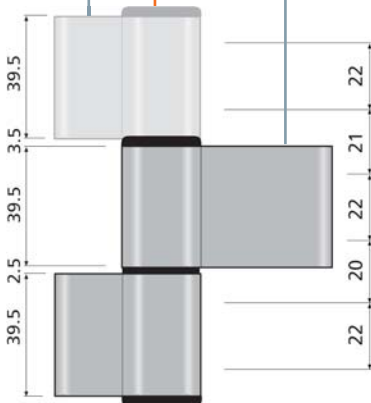

Adjustable spacer bushings (not included in scope of supply) prevent the thermal insulation zone from being crushed. Please request installation overview.



Door/frame combination for outward opening doors with alternating section (example)		Door/frame combination for corner post construction (example)		Colour key	Mounting	Your stock number	Drilling jigs	
Pivot 20 mm		Pivot 36 mm		Other colours available. Please indicate separately. 0 = unfinished, for anodisation 1 = EV1 anodised 2 = unfinished, for coating 3 = dark bronze anodised 4 = RAL 9010 coated 5 = RAL 8077 coated 6 = RAL 9016 coated X = other colour as per specification	Plates 15 21	Expansion bushing	Basic designation Colour number Mounting plate	Item number T□□□A0000
Pivot 20 mm		Pivot 36 mm						
							A7□□□ 000 □	209 259
							A7□□□ 000 □	201 251
							A7□□□ 000 □	207 257
							A7□□□ 000 □	215 265
							A7□□□ 000 □	213 263
A711 A761	A712 A762						A7□□□ 000 □	211 261
*** A767	A718 A768						A7□□□ 000 □	217 267
*** A773	A724 A774						A7□□□ 000 □	223 273
A705 A755	A706 A756						A7□□□ 000 □	205 255
*** A769	A720 A770						A7□□□ 000 □	219 269
*** A771	** A772						A7□□□ 000 □	221 271
		A749* A799*					A7□□□ 000 □	249 299
		A748* A798*					A7□□□ 000 □	248 298

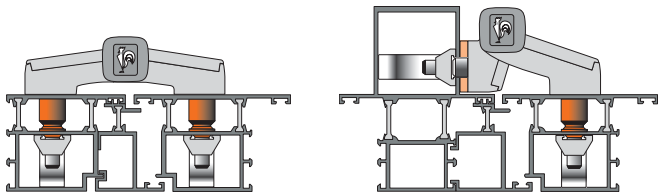

*) In case of corner posts it is frequently necessary to apply furring to the hinge plate – that is why you generally need to indicate the number of our drawing or profile section system with section number when ordering hinge and drilling jig. When ordering corner post constructions, please indicate the profile section system and door/frame combination. Include profile section drawing when ordering furring for hinge base. Factory assembly necessary.

Sample order

- Hahn Universal Hinge Series 60 AT
2-piece
Bore hole gauge 62.5 mm
Pivot 20 mm
Assigned number as per product overview: A701_000_
A701 000
- RAL 9010 coated
A701 400
- Mounting plate
21 mm
A701 400 1

Alternative designs and combinations based on installation drawing or their description: Designs and combinations receive individual stock numbers.



Installation with Hahn screw anchor

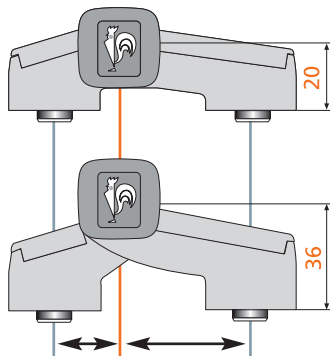

Bore hole gauge	Door/frame combination for inward opening doors (example)		Door/frame combination for outward opening doors (example)		Door/frame combination for inward opening doors with alternating section (example)	
	20 mm	36 mm	20 mm	36 mm	20 mm	36 mm
17 42 mm	59 mm	A703 A753 **) (**)	A703 A753	**) (**)		
17 50 mm	67 mm	A709 A759 **) (**)	A709 A759	**) (**)		
20.5 42 mm	62.5 mm	A701 A751 **) (**)	A701 A751	**) (**)		
20.5 50 mm	70.5 mm	A707 A757 **) (**)	A707 A757	**) (**)		
17 57.5 mm	74.5 mm				A715 A765	**) (**)
20.5 57.5 mm	78 mm				A713 A763	**) (**)
42 42 mm	84 mm					
42 50 mm	92 mm					
42 57.5 mm	99.5 mm					
47 42 mm	89 mm					
47 50 mm	97 mm					
47 57.5 mm	104.5 mm					
20.5 42 mm						
20.5 57.5 mm						

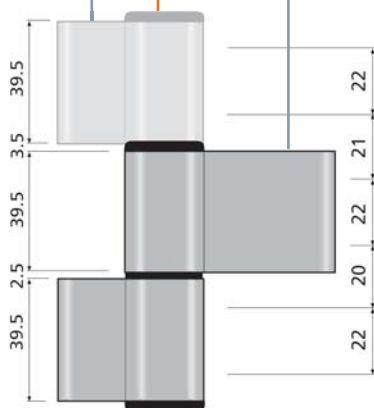

**) Item number on request

***) We recommend using a 3-piece variation

- W Screw anchor, long, 50 mm length, effective length = 39 mm, steel yellow zinc plated
- Y Screw anchor, long, 50 mm length, effective length = 39 mm, stainless steel
- S Screw anchor, long, 50 mm length, effective length = 39 mm, black
- T Screw anchor, short, 42 mm length, effective length = 31 mm, steel yellow zinc plated
- V Screw anchor, short, 42 mm length, effective length = 31 mm, stainless steel
- M Screw anchor, very long, 55 mm length, effective length = 48.5 mm, steel yellow zinc plated

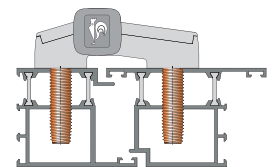

The Hahn screw anchor prevents the thermal insulation zone from being crushed.



Door/frame combination for outward opening doors with alternating section (example)		Door/frame combination for corner post construction (example)		Colour key	Mounting	Your stock number	Drilling jigs
 Pivot 20 mm Pivot 36 mm 		 Pivot 36 mm 		0 = unfinished, for anodisation 1 = EV1 anodised 2 = unfinished, for coating 3 = dark bronze anodised 4 = RAL 9010 coated 5 = RAL 8077 coated 6 = RAL 9016 coated X = other colour as per specification	Screw anchor 42 mm made of steel Screw anchor 42 mm made of stainless steel Screw anchor 50 mm made of steel Screw anchor 50 mm made of stainless steel Screw anchor 55 mm made of steel Screw anchor 50 mm for steel sections	Basic designation Colour number Screw anchor varieties	 Item number T□□□A0000
				0 1 2 3 4 5 6	T V W Y M S	A7□□□□ 000	2 0 3 2 5 3
				0 1 2 3 4 5 6	T V W Y M S	A7□□□□ 000	209 259
				0 1 2 3 4 5 6	T V W Y M S	A7□□□□ 000	201 251
				0 1 2 3 4 5 6	T V W Y M S	A7□□□□ 000	207 257
				0 1 2 3 4 5 6	T V W Y M S	A7□□□□ 000	215 265
				0 1 2 3 4 5 6	T V W Y M S	A7□□□□ 000	213 263
A711 A761	** **)			0 1 2 3 4 5 6	T V W Y M S	A7□□□□ 000	211 261
*** A767	** **)			0 1 2 3 4 5 6	T V W Y M S	A7□□□□ 000	217 267
*** A773	** **)			0 1 2 3 4 5 6	T V W Y M S	A7□□□□ 000	223 273
A705 A755	** **)			0 1 2 3 4 5 6	T V W Y M S	A7□□□□ 000	205 255
*** A769	** **)			0 1 2 3 4 5 6	T V W Y M S	A7□□□□ 000	219 269
*** A771	** **)			0 1 2 3 4 5 6	T V W Y M S	A7□□□□ 000	221 271
	*) ** *) **)			0 1 2 3 4 5 6	T V W Y M S	A7□□□□ 000	249 299
	*) ** *) **)			0 1 2 3 4 5 6	T V W Y M S	A7□□□□ 000	248 298

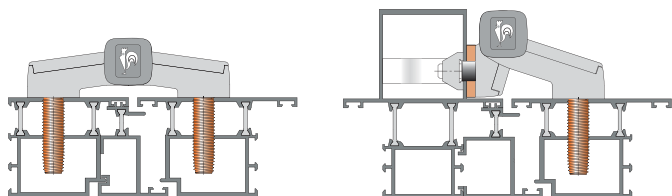

*) In case of corner posts it is frequently necessary to apply furring to the hinge plate – that is why you **generally** need to indicate the number of our drawing or profile section system with section number when ordering hinge and drilling jig. When ordering corner post constructions, please indicate the profile section system and door/frame combination. Include profile section drawing when ordering furring for hinge base. Factory assembly necessary.

Sample order

- 1 Hahn Universal Hinge Series 60 AT
 3-piece
 Bore hole gauge 89 mm
 Pivot 20 mm
Assigned number as per product overview: A756_000
A756 000
- 2 Dark bronze anodised
A756 3 000
- 3 Screw anchor varieties 50 mm steel
A756 3W 000

Alternative designs and combinations based on installation drawing or their description: Designs and combinations receive individual stock numbers.

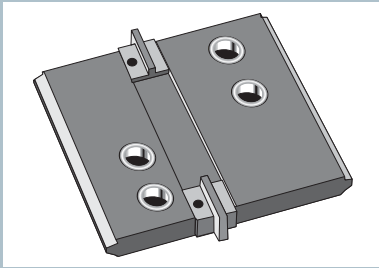

Drilling jig consisting of:

- 1 drill plate
- 3 pairs spacers for shadow groove (SN) (4, 5, 6 and 7 mm)
- 2 grooved pins Ø 5 mm for self-installation

Spacers

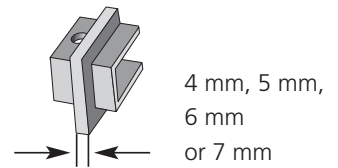

Item numbers see page 10

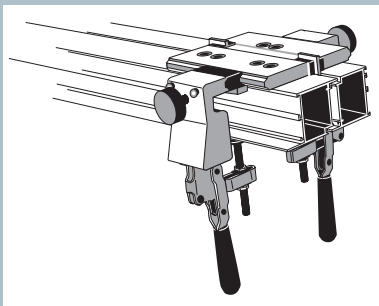

Add-on set for setting up a quick-clamping drilling jig consisting of:

- 2 clamping units
- 2 large spacers with 4 screws M6x75
- 1 small spacer with 2 screws M6x60
- 4 screws M6x40 (for installation without spacers)

The add-on set is mounted on the existing drilling jig. The quick-clamping drilling jig is suited for projected widths up to approx. 90 mm (frame) or approx. 110 mm (leaf).

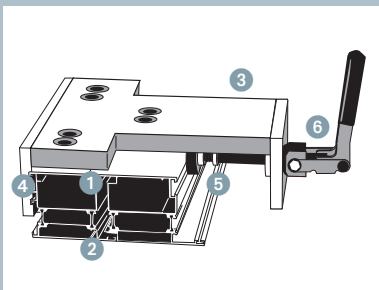

Quick-clamping drilling jig

- 1 Omission of spacers on the hinge side
- 2 No longer necessary to twist sections
- 3 Less clamping tools – no complicated fastening of drilling jig with screw clamps
- 4 Section-fitted mounting
- 5 Plastic pressure disk to prevent damage to section
- 6 Pretension adjustable to section tolerances

Please contact us if you would like to order a quick-clamping drilling jig.

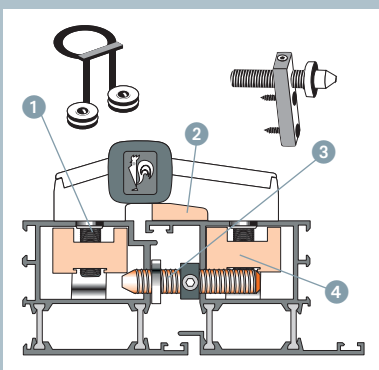

Special accessories for intrusion protection

(Special design for intrusion-resistant doors)

- 1 Set of balls for securing the hexagon sockets of fastening screws for doors that open outwards
- 2 Plate to support the hinge blade on the section
- 3 Collared safety mandrel to prevent the door from being forced open
- 4 Section-based mounting plates
- 5 Snap-off screw



For item numbers see overleaf



Hinge base furring for interleaved doors

Accessories: furring of hinge base, extended eccentric rings, extended screws

Special drilling jig for interleaved doors

Include profile section drawing when ordering. Factory assembly necessary.

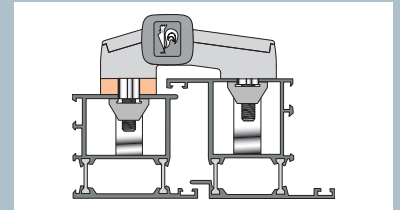

Hinge base furring for corner post construction

In case of corner posts it is frequently necessary to apply furring to hinge plate – that is why you generally need to indicate the number of our drawing or profile section system with section number when ordering hinge and drilling jig.

When ordering corner post constructions, please indicate the profile section system and door/frame combination.

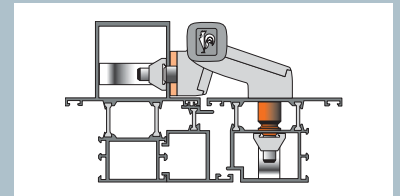

Wide mounting plates for thin-walled steel sections

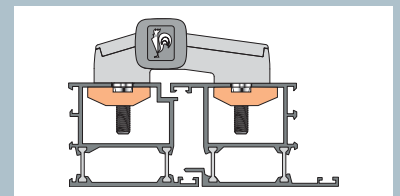

Expansion bushing mounting

- Ø 15 mm
- Minimum wall thickness of profile sections: 2.2 mm
- Max. weight is 80 kg with 2 x 1 m large door leaves
- May only be used with tapered bushes

Factory assembly necessary. Drilling jigs and designs for walls thicker than 3 mm available on request.

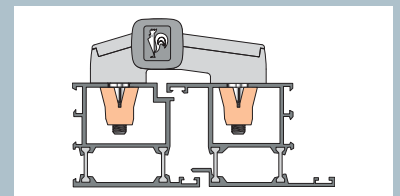

Special rust-proof version

Mounting plate

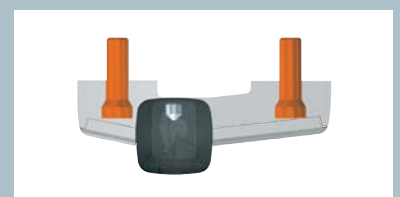

Folding door hinges

Hinge for roller unit, suitable for folding door hinges **M12** and **M16**

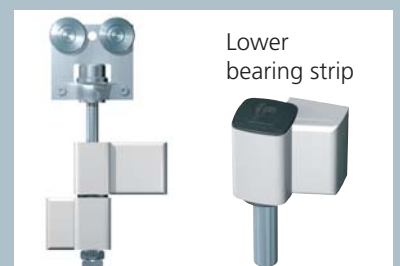
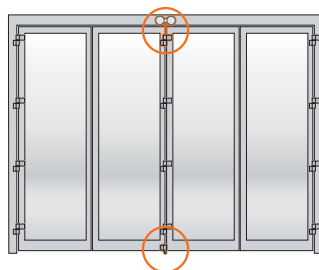

Lower bearing strip

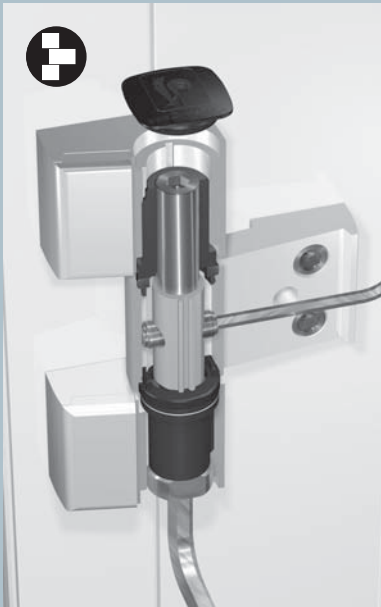

1 Item number on request



2 Item number on request



3 Item number on request



4 Item number on request



5 Item number on request



6 A700E0010



7 A700K0004



8 A700B0000
A700B0001



9 A700K0000



10 A700K0001



11 A700G0000



12 A700K0002



13 A700K0003



14 E1512801



15 D914M6X6

- | | |
|-------------------------------------|------------------------------|
| 1 Frame hinge blade | 9 Bearing bushing |
| 2 Door hinge blade | 10 Upthrust washer |
| 3 Cover strip for frame hinge blade | 11 Pressure spindle |
| 4 Cover strip for door hinge blade | 12 Cap for door hinge blade |
| 5 Mounting plate | 13 Cap for frame hinge blade |
| 6 Eccentric ring 6 mm | 14 Screw M8x25 |
| 7 Plastic locking plug | 15 Set-screw M6x6 |
| 8 Bearing pin | |

Screw anchor installation instructions

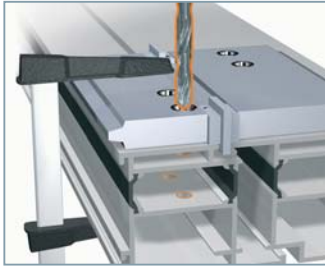

Clamp drilling jig, drill 11 mm diameter holes

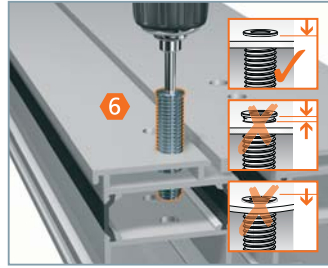

Screw-in screw anchor until flush with surface – through at least 2 walls each with 1.6 mm.

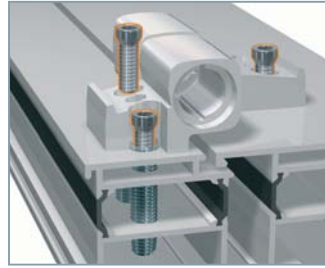

Secure hinges with screws in the internal threading of the screw anchor (20–30 Nm).

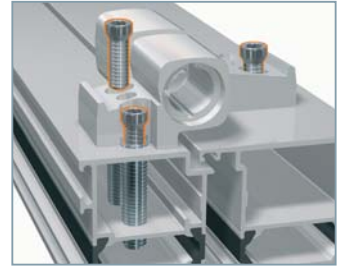

Processing view of doors opening inward.

Screw anchor version	Item no.	Code letter in connection with complete hinge
Screw anchor, long, 50 mm length, effective length = 39 mm, steel yellow zinc plated	A700E0008	W
Screw anchor, long, 50 mm length, effective length = 39 mm, stainless steel	A700E0009	Y
Screw anchor, long, 50 mm length, effective length = 39 mm, black	A700E0021	S
Screw anchor, short, 42 mm length, effective length = 31 mm, steel yellow zinc plated	A700E0012	T
Screw anchor, short, 42 mm length, effective length = 31 mm, stainless steel	A700E0013	V
Screw anchor, very long, 55 mm length, effective length = 48.5 mm, steel yellow zinc plated	A700E0023	M



Adjustable distance bushes

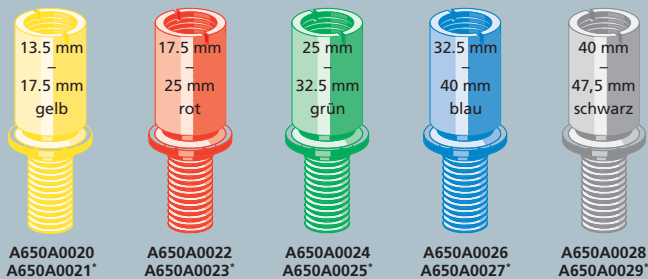

The Hahn Series 60 AT must be mounted with plates, and possibly adjustable spacers if need be, on profile sections that have a wall thickness of less than 1.6 mm. There are special technical versions for these particular applications.

* Rust-resistant design



Use Hahn counterbore to drill out the 11 mm-diameter holes to a 15 mm diameter. Do not drill through main chamber.



Screw support stud screw with mounting plate (special screwdriver). Recommended tightening torque 12 to max. 17 Nm. The collar should rest on the main chamber.





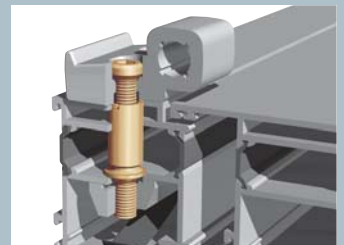







Screw spacer bush on to threaded support stud, until it is flush with the surface of the profile section.



Secure hinges with screws in the internal threading of the support stud. Recommended tightening torque 20 to 30 Nm.

Hahn Series 60 AT

Item numbers Accessories

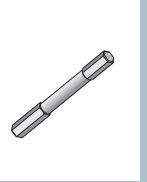
Positioning aid	Slip-type drill bush 5 mm/ 11 mm	Step drill 11 mm diameter	Ball set	Safety mandrel	Safety mandrel with collar
					
A650A0039	A650A0056	A650A0035	A850A0011	A650A0017	A850A0000
Counterbore 11 mm/ 15 mm	Special screw driver for adjustable distance bushes	BIT screw driver for adjustable distance bushes	Drawing tool (for 3-piece hinges)	Security kit (for 3-piece hinges)	Special bit for screw anchors and fastening screws
					
A650A0033	A650A0036	A650A0037	A850A0015	A650A0107	A750A0027



T: +44 (0) 116 2289 3343 E: info@facadecreations.co.uk W: www.facadecreations.co.uk
Registered in England, Company Number: 16267073